

SIZZLIN' SEARCH

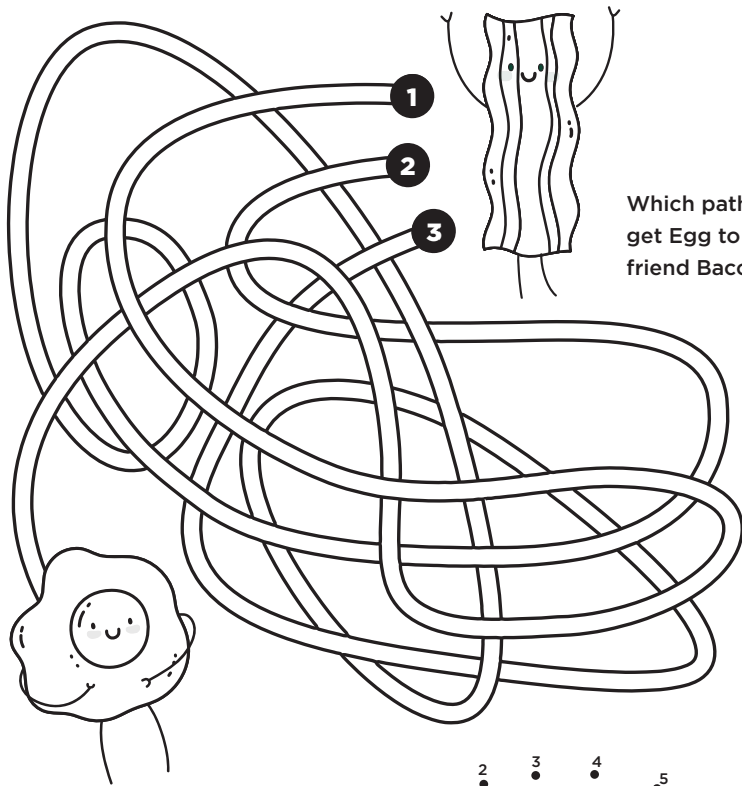

Which path will get Egg to his friend Bacon?

SCRAMBLED WORDS

Unscramble these words.

FLAWFE

INKCEHC DRNEETS

ANOBC

ACM NAD EEHCSE

LEARN TO DRAW

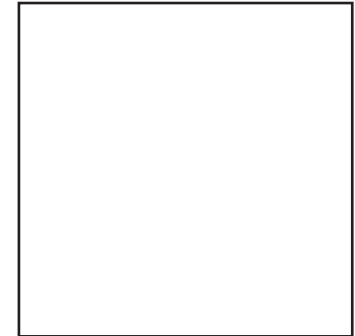
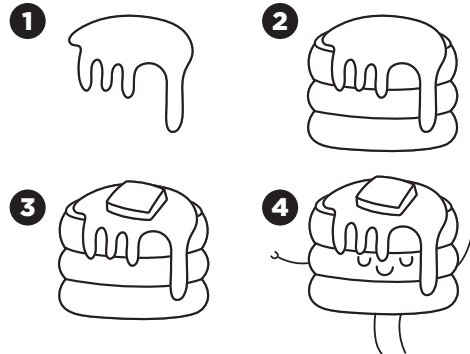

Draw Here!

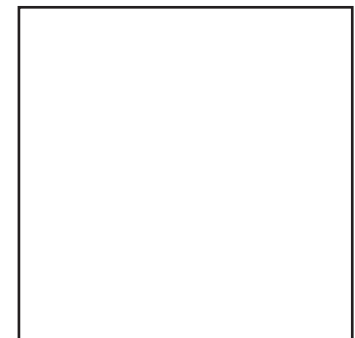
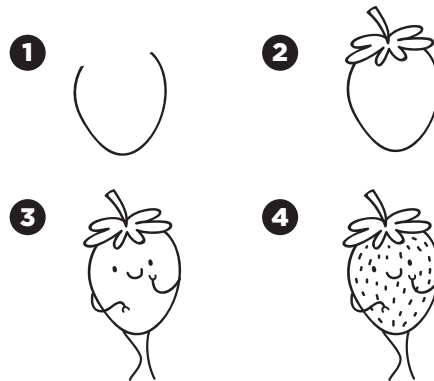

Draw Here!

KIDS EAT FREE!



metro
-diner-

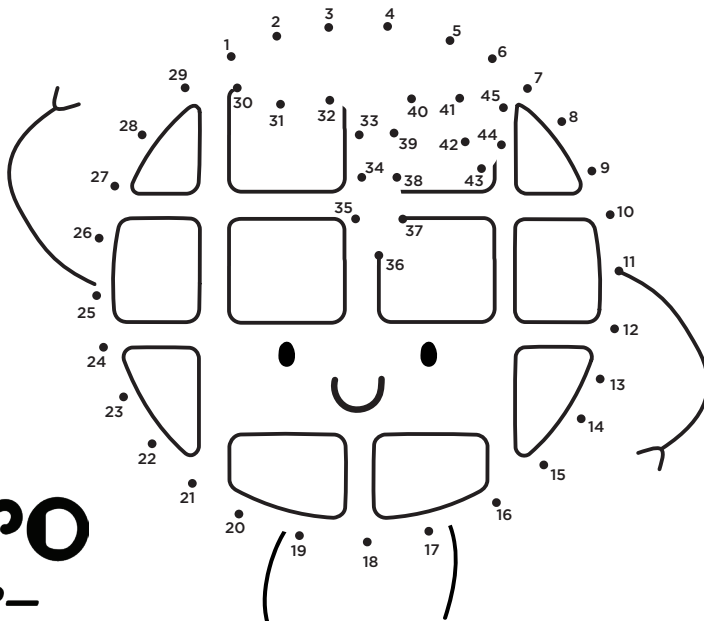

waffle / chicken tenders / bacon / mac and cheese